



**7 Foxhills Close Ottershaw Surrey KT16 0NH**

**£635,000**







## Foxhills Close, Chertsey, KT16

Total internal area: approx. 194.5 sq. metres (2096 sq. feet)

Main area: approx. 178.2 sq. metres (1921 sq. feet), inc. limited use space: approx. 6.4 sq. metres (68.9 sq. feet)

Garage: approx. 16.3 sq. metres (175 sq. feet)

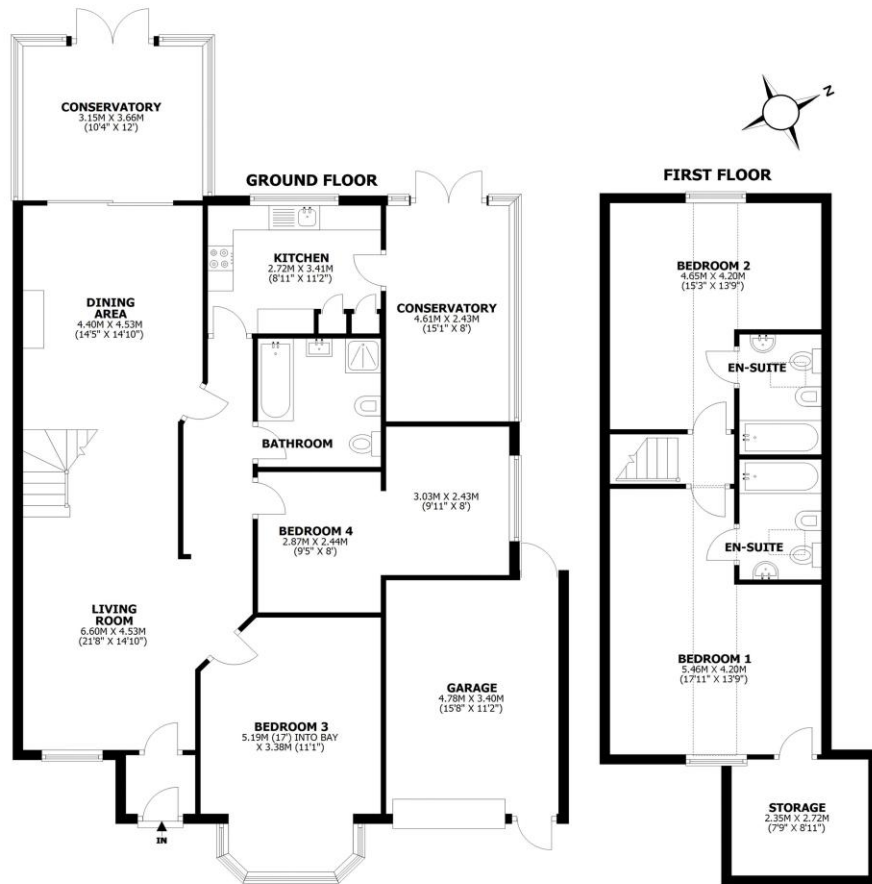

This floorplan is for illustrative guidance only and is not to drawn to scale. Whilst every attempt has been made to ensure accuracy, measurements are approximate and should not be relied upon as a matter of fact. Maximum dimensions are given excluding small alcoves, etc unless otherwise stated.

Situated within a peaceful cu-de-sac location in the popular and desirable village of Ottershaw, is this versatile four-bedroom three-bathroom detached chalet bungalow. With four generous bedrooms and three bathrooms (two of which are ensuite) this versatile property offers ideal family living. This is complemented by an open-plan double reception room featuring a central staircase rising to two double bedrooms both with ensuites. There are two further bedrooms on the ground floor sharing a third bathroom and a modern kitchen. Two conservatories offer additional living space overlooking the west facing rear garden accessing Ottershaw memorial park which features two tennis courts, bowling green, cricket pitch and a playground. The front of the property benefits from a private driveway leading to a garage. Transport links are provided by junction 11 of the M25 and we are within easy reach of Woking railway station into London Waterloo. The village of Ottershaw has your local amenities all at hand including popular local schools and nurseries. EPC Rating D.



**AGENTS NOTES:** These details do not constitute any part of an offer or contract. In issuing them we do not have any authority to give any warranty or representation whatsoever in respect of this property. These details are provided without any responsibility on our part or the part of the vendors. No statements in these details are to be relied upon as representations of fact and purchasers should satisfy themselves by inspection or otherwise as to the accuracy of the statements contained therein.

**Equipment:** We have not tested the equipment or central heating system mentioned in these particulars and purchasers are advised to satisfy themselves as to their working order and condition.

**Measurements:** Great care is taken when measuring but measurements should not be relied upon for ordering carpets, equipment, etc.